



## Belfast City Council

<b>Report to:</b>	Strategic Policy and Resources Committee
<b>Subject:</b>	<b>Provision of a Smoking Shelter in the City Hall Courtyard</b>
<b>Date:</b>	9 <sup>th</sup> November, 2012
<b>Reporting Officer:</b>	Gerry Millar, Director of Property and Projects, ext 6217
<b>Contact Officer:</b>	George Wright – Head of Facilities Management, ext. 5206/6232

<b>1</b>	<b>Relevant Background Information</b>
1.1	Members will be aware that there is currently no provision made for a dedicated outdoor sheltered smoking facility at the City Hall.
1.2	Many of those who do smoke currently use an outdoor area adjacent to the goods lift entrance in the south east corner of the courtyard.
1.3	Although the number of smokers has reduced in recent years there is still a significant number of staff and visitors, especially those attending wedding and civil partnership services and functions, who do smoke and who frequently congregate at the main access points to the building, especially during inclement weather.

<b>2</b>	<b>Key Issues</b>
2.1	The current Council smoking policy does not preclude the provision of a smoking shelter so long as it does not pose a Health and Safety risk or is close to adjacent doors, windows, ventilation inlets etc.
2.2	It must also be acknowledged that there have been increasing suggestions recently from a number of staff that making some dedicated provision would be desirable and beneficial for smokers, and it is felt that this could be achieved in a cost-effective and unobtrusive way through the installation of a purpose-built shelter.
2.3	Having a shelter would allow the main City Hall access points to be kept clear of smokers and is would be a positive development from a passive smoking and aesthetic perspective.
2.4	An area of the courtyard behind the toilet block adjacent to the goods lift entrance in the south east corner of the courtyard has been identified as a suitable location for the shelter. It is within close proximity to the open air area currently used by some smokers and is not readily visible to people visiting the building (see Appendix 1A).

2.5	The proposed shelter (see Appendix 1B) is constructed from steel and perspex glass, with dimensions of 2200mm x 1000mm, and would accommodate approx. 6-8 smokers at any one time. The colour would be in keeping with the Portland stone of the building.
2.6	If the shelter is approved and implemented, it is proposed that the council seeks to encourage its use by staff and visitors, and also seeks to actively discourage smoking in the other high-profile areas through the use of appropriate signage and other measures.

<b>3</b>	<b>Resource Implications</b>
----------	------------------------------

3.1	The cost for the smoking shelter and ancillary bins would be approximately £2,500 and provision has been made for the item in the City Hall revenue budget.
-----	---

<b>4</b>	<b>Equality and Good Relations Considerations</b>
----------	---

4.1	The smoking shelter would be available to all smokers and be fully accessible for people with mobility issues.
-----	--

<b>5</b>	<b>Recommendations</b>
----------	------------------------

5.1	It is recommended that a smoking shelter is purchased and located in the Courtyard at the location indicated.
5.2	It is further recommended that the council seeks to discourage smoking at other main locations through the use of appropriate signage.

<b>7</b>	<b>Key to Abbreviations</b>
----------	-----------------------------

	None
--	------

<b>8</b>	<b>Documents Attached</b>
----------	---------------------------

	<p>Appendix 1A - location map</p> <p>Appendix 1B – sample shelter</p>
--	---

# APPENDIX 1

(A)

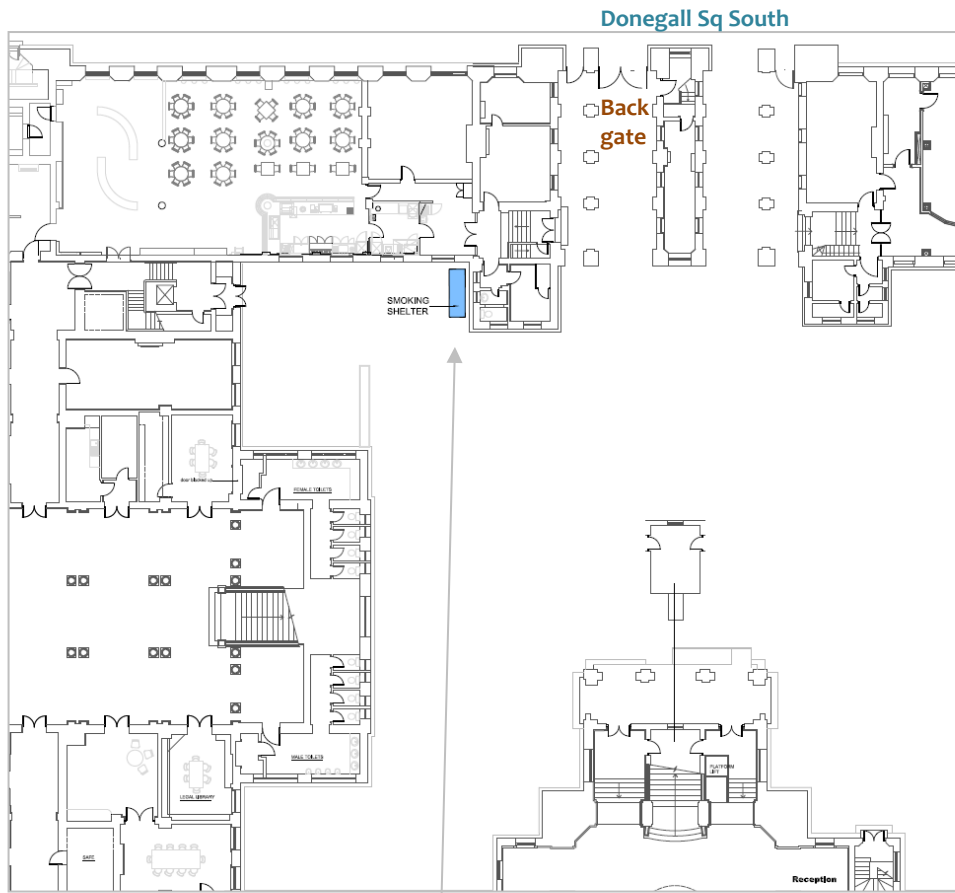

(B)

